

# STUDIO 1



## OVERVIEW



## LOGES

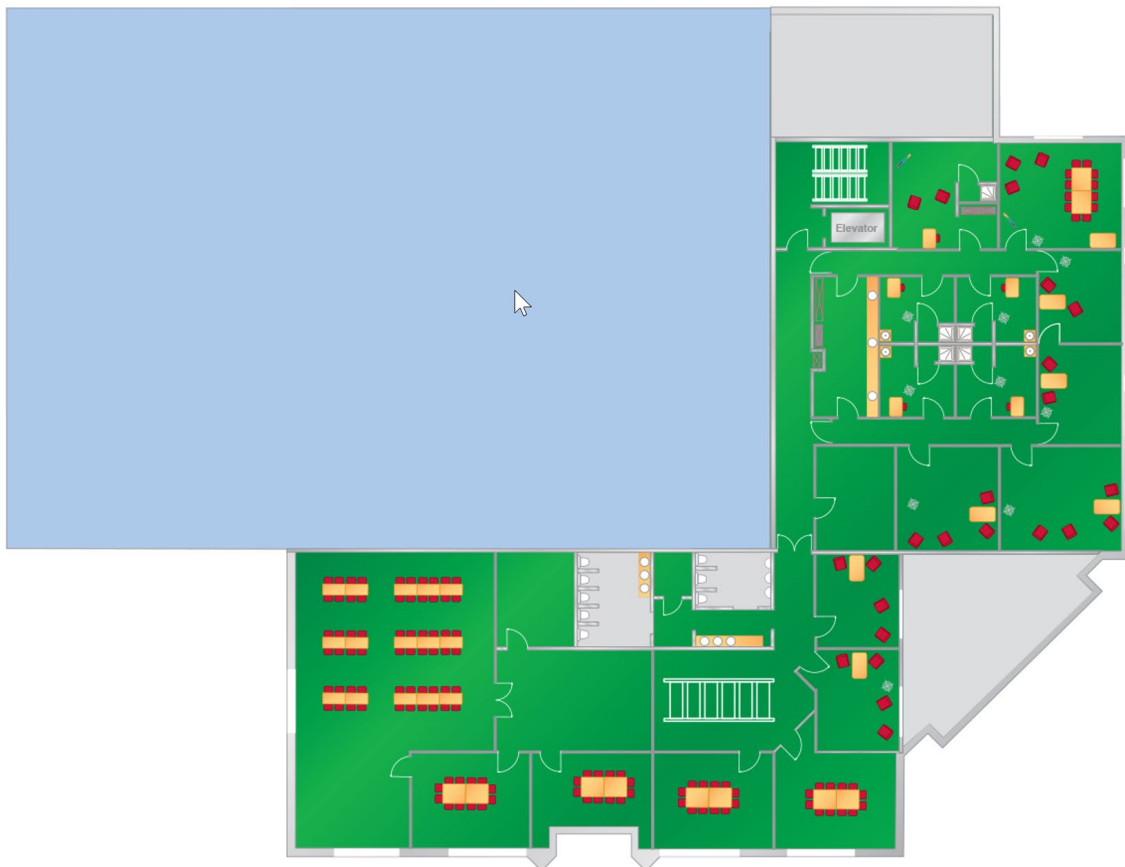

# STUDIO 1



## STUDIO FLOOR

---

- surface area: 34.70 m x 24.00 m (833.00 m<sup>2</sup>) x 10 m (h)
- usable surface area: 32 m by 22 m (704 m<sup>2</sup>) x 8 m (h)
- floor load capacity: 1,000 kg/ m<sup>2</sup> the floor is made of special synthetic rubber PMP Coating (so the floor can be painted)

## CYCLORAMAS AND SCREENS

---

the cyclorama system has 3 possible circuits on rails:

- one circuit covers the entire studio
- one circuit for half the studio on the left
- one circuit for half the studio on the right

the following screens are provided:

- 1 fireproof neutral light grey cyclorama: 8 m x 80 m, approx. 2/3 studio
- 1 fireproof neutral light grey cyclorama: 8 m x 60 m, approx. 1/2 studio
- black velvet stage screens, min. reflection, max. absorption, 8 m x 1/1 studio

## POWER

---



230v/400v  
4 x 125 A  
3 x 63 A,  
3 x 32 A  
1 x 16 A

# STUDIO 1



## LIGHTING

---

112 lighting booms divided over 7 axes  
maximum useful load per light boom: 120 kg  
average vertical shift: 120 mm/sec

between passageway and cyclorama lighting suspension:  
lighting booms (approx. 2 m wide)  
inside studio lighting suspension: 5 rows of lighting booms (approx. 2.8 m wide)

### Lighting boom control panel

The manual operating panel for the lighting booms is located on the central passageway. It includes the required control electronics and selection switches for the 112 lighting booms.

### Lighting control system

#### Chamsys QuickQ 20

- dimmer units ADB type CTVIEI24
- 296 dimmers of 5 kW type ATVIBI5
- 24 dimmers of 10 kW type ATVIBI10
- a manually operated ADB type patch panel
- TR 721144

two small dimmer cases ADB Europack 6 x 5 kW on CEE sockets  
• DMX 512 input- 220/380 power supply.

Part of the light channels has cabling running to one or more connection panels in the studio.

- 112 x 2 channels on lighting booms
  - 112 x 1 patching on lighting booms
  - 32 x 1 patching on studio floor
  - connection panel
  - 24 x 10 kW channel for the cyclorama screen
  - cyclorama brackets ceiling/floor
  - studio floodlights with Fresnel lens
  - softlight flat light arm with ind sym refl 2 or 2x2
  - profile floodlight 17°-35° condenser obj (15°-31°)
  - followspots (with HMI lamp)
  - parblazers
  - pantographs (1.5 m/30 kg)x5
  - pantographs (2.1 m/50 kg)x5
- |              |                               |
|--------------|-------------------------------|
| 1 kW         | x 48 in ceiling /35 on ground |
| 1/2/5 kW     | x 40/48/40                    |
| 1.25/2.5/5kW | x 10/12                       |
| 1/2/1.2 kW   | x 12/6/12                     |
| 1.2 kW       | x 2                           |
| 1kW          | x 60                          |