

STUDIO 2

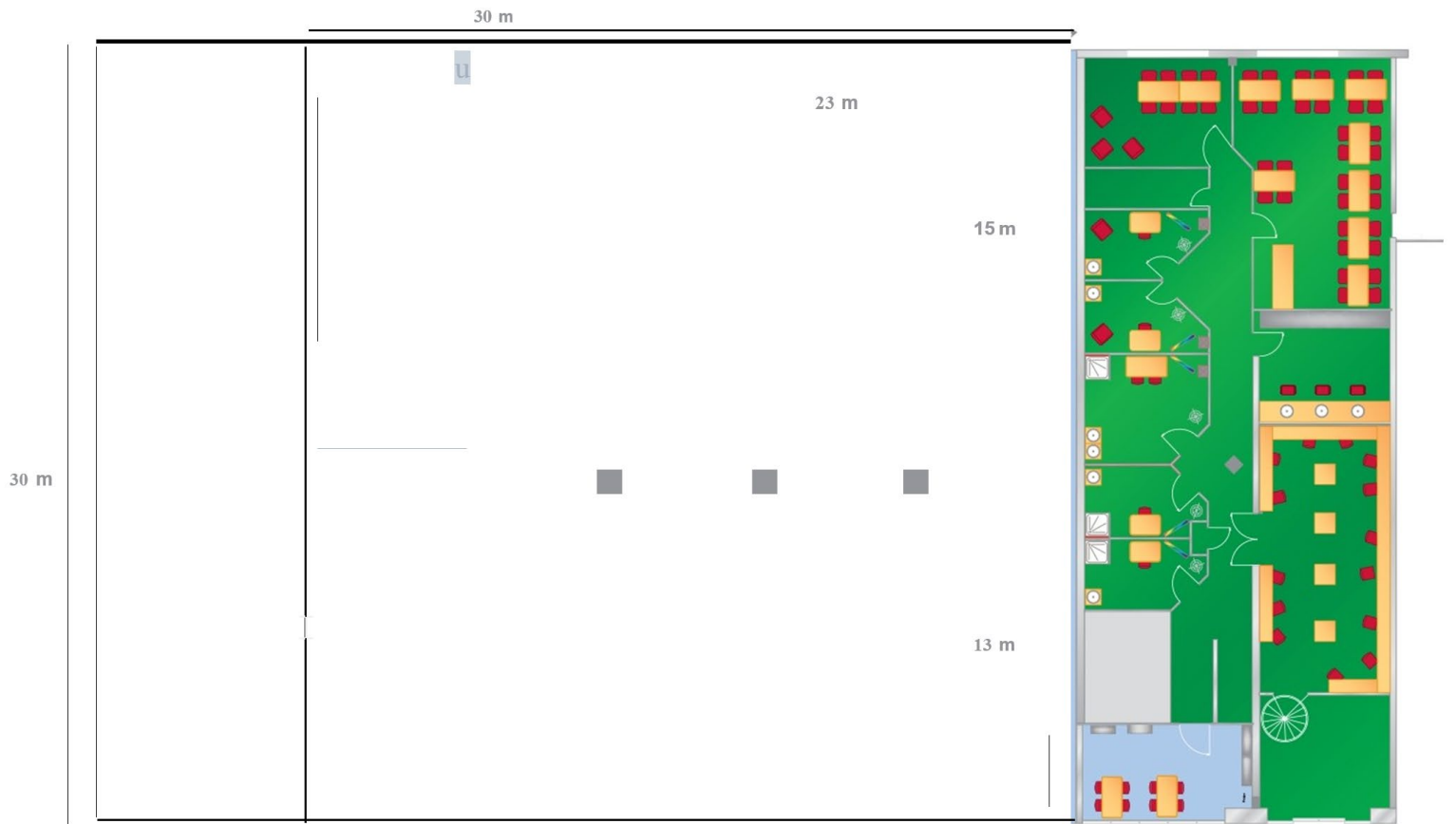

OVERVIEW



STUDIO 2



STUDIO FLOOR

surface area: 30.00 m x 28.60 m (737.00 m²)

usable surface area: 15.3 m x 23 m and 13.30 m x 23 m

floor load capacity: 1,000 kg/ m² the floor is made of special synthetic rubber PMP Coating (so the floor can be painted)
The floor is made of polished concrete.

CYCLORAMAS AND SCREENS

the following screens are provided:

1 fireproof neutral black cyclorama: 40 m
black velvet stage screens, min. reflection, max. absorption, 1/1 studio

POWER

 2 x 125A
1 x 63A
2 x 32A

LIGHTING

Lighting control system

- Chamsys QuickQ20
- 10 dimmers of 12 x 3 kW type MEMORACK30

Cyclorama brackets

Studio floodlights with Fresnel lens:

Softlight flat light arm with ind sym refl 2 lin halog:

Profile floodlight 13°-36°/ 38°- 57°:

Floorcan:

8 x 1 kW

16/40/45 x 500/1/2 kW

10 x 2.5 kW

2/10 x 211.2 kW

10 x 1kW