

# STUDIO 6

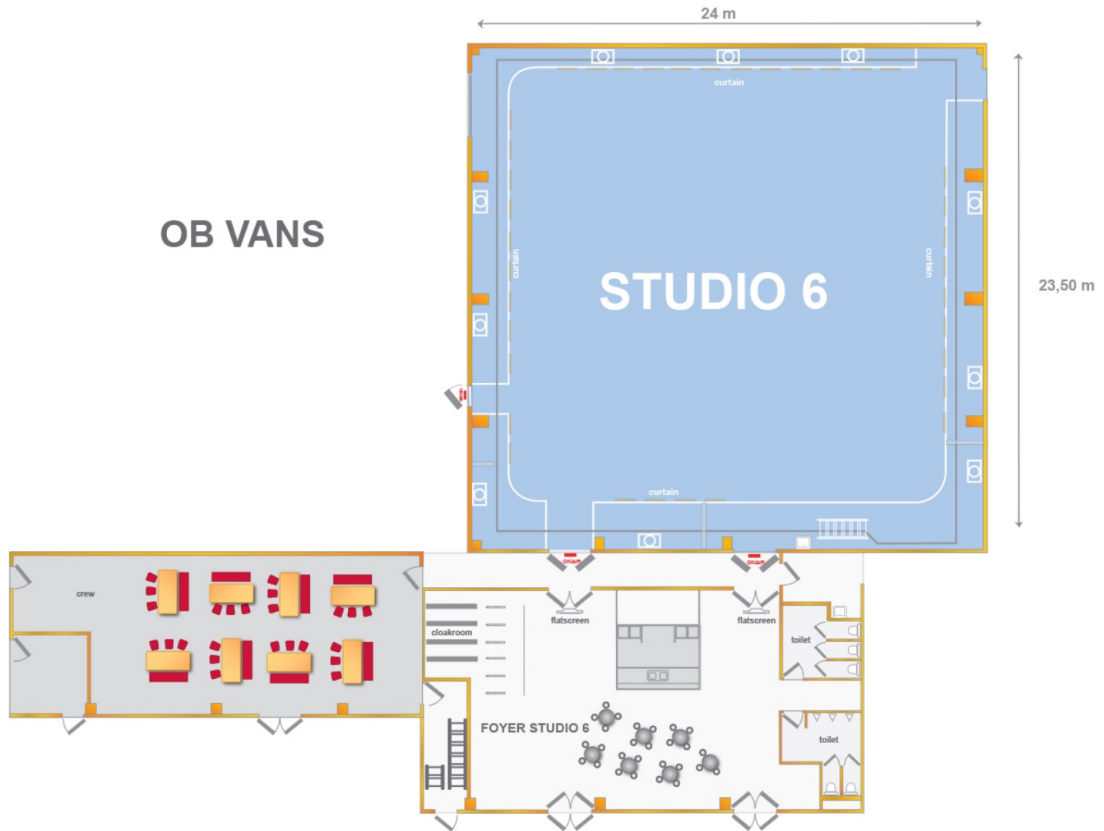

## OVERVIEW



## LOGES



# STUDIO 6



## STUDIO FLOOR

---

surface area: 24 m x 23,50 m

usable surface area: 20,40 m x 20,40 m

floor load capacity: 1,000 kg/ m<sup>2</sup> the floor is made of special synthetic rubber PMP Coating (so the floor can be painted)

Rigging:

- 1profiel ( 112/220) intire studio: height 9650 mm
- max. levy of the structure: 100 kg/m<sup>2</sup> (10 kN =1.000kg)
- 4x structure Prolyte H40 square black 7000 mm l 7000 mm

every structure hangs on 4 x 1 ton motors with double break, height bottom 8550 mm

## CYCLORAMAS AND SCREENS

---

black molton fondcloths, heigth 9500 mm, length studio 111

## CONTROLE DESK

---

ADB Mentor 2x Dmx 512

## POWER



1x 400A Powerlock 2x  
125A CEE  
4x 63ACEE  
3x 32ACEE  
7x 16A Schuko

## Dmx en UTP RJ 45

---

Dmx 5 pin and UTP RJ 45 on 4 places in the studio

## ACCESS

---

Gate studio to stagehal, width 3000 mm, heigth 5970 mm

Gate stagehal to outside, width 3990 mm, heigth 4490 mm in the studio

# STUDIO 6



## LIGHTING

---

- 10x fresnel 500w 40x fresnel 1000w
- 40x Fresnel 2000w 8x fresnel 5000w
- 12x soft 2500w
- 12x warp 800w (12° tot 30°)

## DIMMER

---

- 144x 2,5 Kw exported on socapex with break out box to schuko
- 35x 5 Kw exported on harting with break out box to CEE 32A blauw
- Total maximum assessable till 400A 3P